

บอลวาล์วสองชิ้นสแตนเลส 316

หน้าแปลน 150 LBS

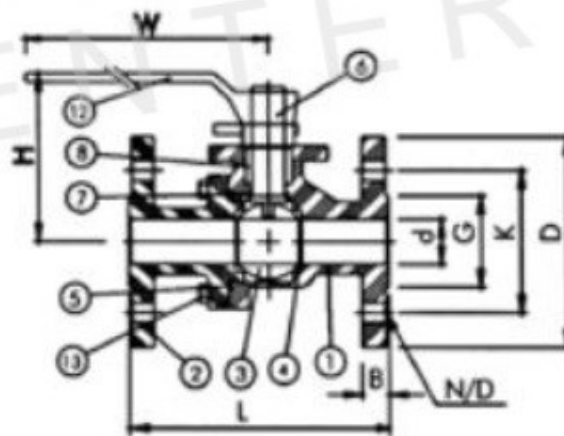
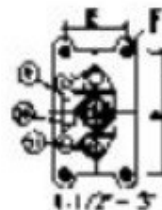
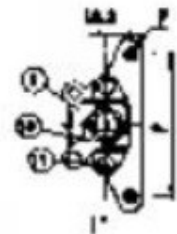
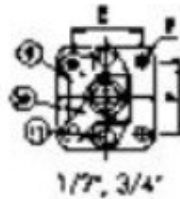

- * Flange: ANSI B16.5 Class 150.
- * Face To Face: ANSI B16.10
- * Anti-Static Device, Fire Safe Design.
- * Blow-Out Proof Stem, Lever Operated.
- * Full Port, Solid Ball / Hollow Ball.
- * Available with ANSI 300, DIN PN16/PN40.

Material

Model	V-2F
1 Body	A351-CF8M
2 Cap	A351-CF8M
3 Ball	A351-CF8M
4 Seat	PTFE
5 Stem	SS 316
6 Gasket	PTFE
7 Thrust Washer	PTFE
8 Packing	PTFE
9 Stem Packing	PTFE
10 Gland	AISI 304
11 Gland Bolt	ASTM 194-B8
12 Handle	AISI 304
13 Stopper	SS 304
14 Snap Ring	SS 304
15 Bolt	ASTM 194-B8

Dimension

mm

Size	inch	1/2	3/4	1	1.1/4	1.1/2	2	2.1/2	3	4	5	6	8	10	12	14
	mm	15	20	25	32	40	50	65	80	100	125	150	200	250	300	350
Bore Size d		12	20	25	32	40	50	65	80	98	125	150	198	250	300	350
L		108	117	127	140	165	178	190	203	229	356	394	457	533	610	686
H		85	90	100	105	110	120	160	170	185	260	280	340	400	GEAR	GEAR
W		160	160	160	160	206	206	324	324	324	650	650	850	1000	1000	1000